

All rights reserved.

Electronic Document Name: SZSH-QW-RD-W1125

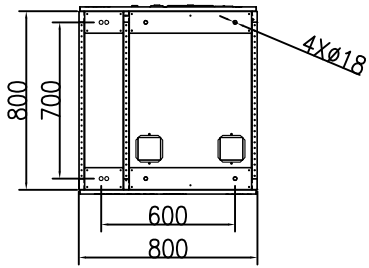
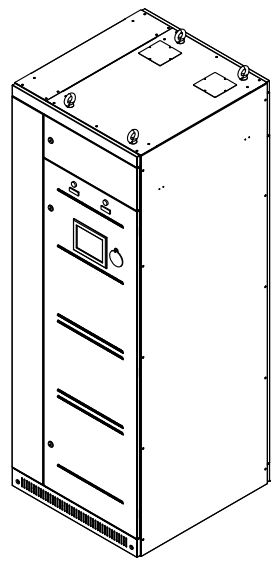
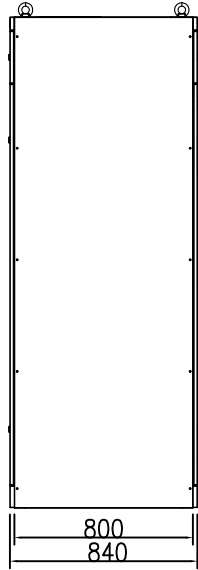
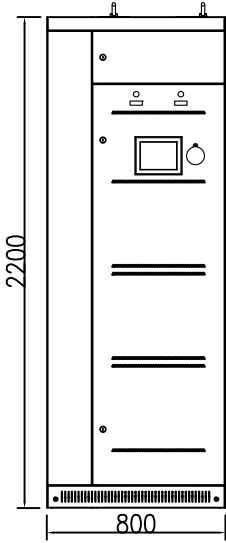

DESIGNED BY	BENNY ZENG
CHECKED BY	
TECK.	
STDN.	
APPROVED BY	

AHF CABINET
OVERALL DIMENSION

C66040124-WX

TOTAL 1 , SHEET 1

Sep/10/2014

PART NO. C66040124

PROJECTION

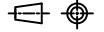

A00			
CURRENT VERSION	REV. NO.	REV. CONTENTS	DATE

All rights reserved.

Electronic Document Name: SZSH-QW-RD-W1125

FRONT VIEW

LEFT SIDE VIEW

BACK VIEW

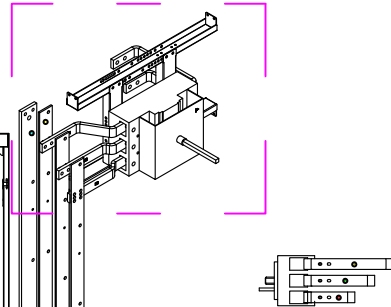
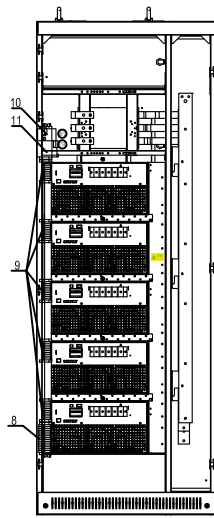
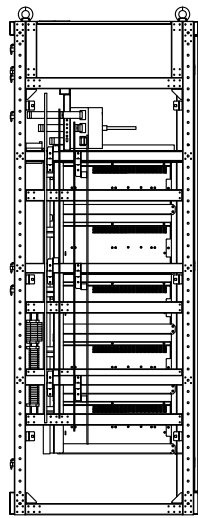
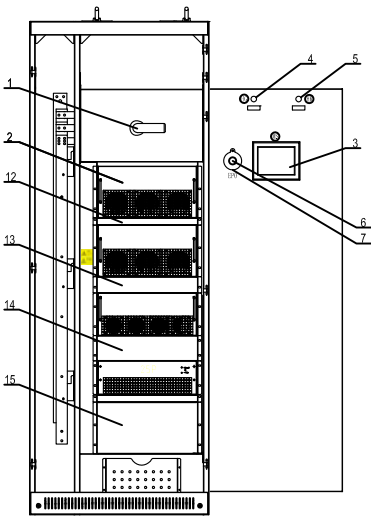

Instructions:
 1, The total number can reach 5 while installing AHF100/AHF50/AHF25 modules.

NO.	SYM.	NAME	SPEC.	PART NO.	QTY.	REMARK
11	FSC	SPD	DUD06-PCS/3+1850(Uc:320WAC)	W29040007	1	Optional
10	QF2	MCB	NOM-63K/63/0	W29010139	1	Optional
9	XT2	Signboard	46_29x97mm		1	Depends on the capacity
		Fastener	1-#K	A20270003	2	
		Tags	0#-5 (-10)	A20270021	2	
		Terminals	DRT83	A20270012	14	
		Cover	D1-S	A20270000	1	
		Bridgewire	6010-5	A20270009	1	
8	XT1	Terminals	LRN/S	A20010023	15	
7		Signboard	0# 46mm, 10 46mm	881140319	1	
6	EPO	Button	LAS(A)-22TS/R/24V	U29010050	1	
5	HR	Indicator	AD16-22B/021S	A22020092	1	
4	IR	Indicator	AD16-22B/021S	A22020089	1	
3	MS	Monitor	PA-MS	988910023	1	
2	M1'S	AHF	150 AHF 44L/RE	C66000128	4	Depends on the capacity
			025P AHF 44L/RE	C66000121	1	
			050P AHF 44L/RE	C66000112	1	
			100P AHF 44L/RE	C66000118	5	
1	QF1	MCB	T6800 PR22105-S1 R800 FF 3P	W29010168	1	1 through 6
			T3250 T00250/2500 FF 3P	W29010113	1	
			T5830 PR22105-S1 R630 FF 3P	W29010044	1	
			N01C-600L/3300 500A	W29010055	1	
			N01C-630L/3300 250A	W29010028	1	
		N01C-630L/3300 630A	W29010033	1		

DESIGNED BY BENNY ZENG
 CHECKED BY
 TECK
 STDN
 APPROVED BY

**AHF CABINET
 LAYOUT & LIST**

C66040124-ZP

TOTAL 1 SHEET 1

REV. NO.	REV. CONTENTS	DATE	APPROVED BY
A00	CURRENT VERSION	Sep/10/2014	

PORT No.	PROJECTION
C66040124	

All rights reserved.

Electronic Document Name: SZSH-QW-RD-W1125

FRONT VIEW

LEFT SIDE VIEW

BACK VIEW

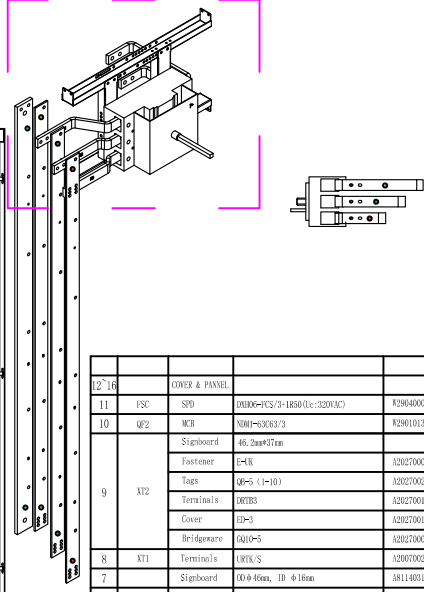
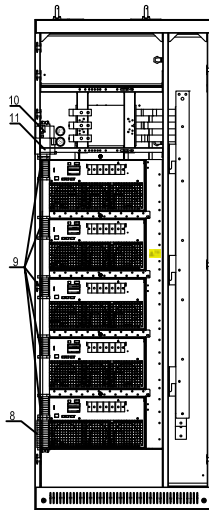
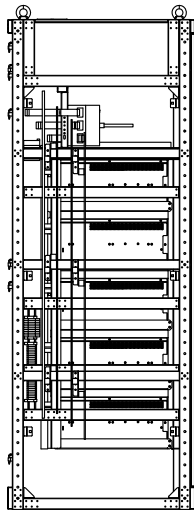
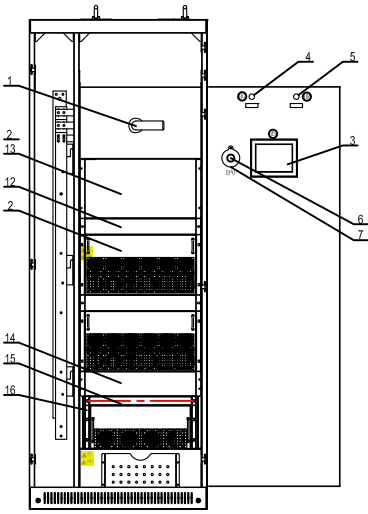

- Instructions:**
- 1, The total number can reach 5 while only installing AHF150 modules.
 - 2, The total number can reach 5 while installing both AHF150 and AHF100/AHF50/AHF25 modules.
 - 3, The total number can reach 5 while ONLY installing SVG100 modules.
 - 4, The total number can reach 5 while both installing SVG50 and SVG100 modules.
 - 5, MCCB can be installed at top or bottom of cabinet

NO.	SYM.	NAME	SPEC.	PART NO.	QTY.	REMARK
12	16	COVER & PANEL				Optional
11	FSC	SPD	YH006-7C5/75-1H50(1c-320V AC)	K2944007	1	Optional
10	QP2	MCB	N100-63C63/3	K29101139	1	Optional
9	XT2	Signboard	46.2mm*97mm		1	Depends on the capacity
		Fastener	E-K	A20270003	2	
		Tags	QP-5 (I=10)	A20270021	2	
		Terminals	HTBS	A20270012	14	
		Cover	TP-5	A20270010	1	
		Bridgeware	Q10-5	A20270009	1	
8	XT1	Terminals	URT/K-S	A20270023	15	
7		Signboard	40*45mm, ID Φ16mm	A81146319	1	
6	EPD	Button	L151-43-2215-B/24P	K29104050	1	
5	IB	Indicator	AD16-220-R1S	A22020092	1	
4	HC	Indicator	AD16-220-G1S	A22020089	1	
3	MS	Monitor	PQ-9S	B66010023	1	
2	HL5	AHF	150 AHF 44L/RE	C66050128	4	Depends on the capacity
			625P AHF 44L/RE	C66050122	1	
			650P 10P 44L/RE	C66050112	1	
			100P AHF 44L/RE	C66050118	5	
1	QP1	MCCB	TEN800 PR22118-4.51 8800 FF 3P	K29101168	1	1 through 6
			TEN250 TM0250/2500 FF 3P	K29101113	1	
			TEN300 PR22118-4.51 9630 FF 3P	K29104044	1	
			N102-800U/3300 800A	K29101035	1	
			N102-250U/3300 250A	K29101028	1	
			N102-630U/3300 630A	K29101033	1	

DESIGNED BY BENNY ZENG

CHECKED BY

TECH.

STDN.

APPROVED BY

AHF CABINET LAYOUT & LIST

C66040124-ZP

TOTAL 1 SHEET 1

AOO

REV. NO.

REV. CONTENTS

Sep/10/2014

DATE

PART NO.

C66040124

PROJECTION



All rights reserved.

Electronic Document Name: SZ5H-QM-RD-W1125

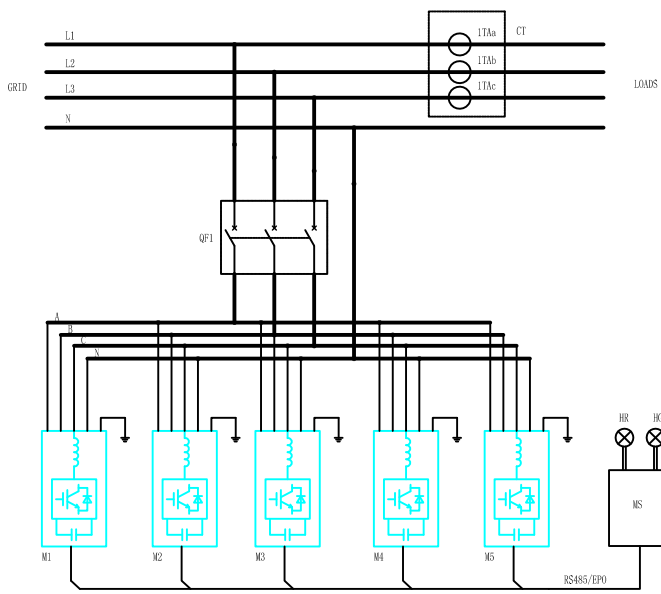

FOR USER

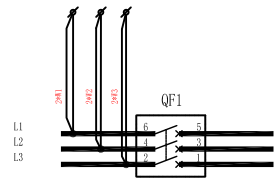

XT1 CT SECONDARY SIDE		terminals
TTAa: S1	1	XT2-5
TTAb: S1	2	XT2-6
TTAc: S1	3	XT2-7
TTAa: S2	4	XT2-8
TTAb: S2	5	XT2-9
TTAc: S2	6	XT2-10
TTAa: S3	7	XT2-11
TTAb: S3	8	XT2-12
TTAc: S3	9	XT2-13
TTAa: S4	10	XT2-14
TTAb: S4	11	XT2-15
TTAc: S4	12	XT2-16

To external CT

XT2 Instructions:
 1. XT2-5, XT2-7, XT2-9 are connected to the terminals of M1-module (1 represented the first one)
 2. XT2-6, XT2-8, XT2-10 are connected to the terminals of Mn-module (n represented the last one which depends on the total capacity)

DESIGNED BY	BENNY ZENG
CHECKED BY	
DATE	Sep/10/2014
APPROVED BY	

AHF CABINET
ELECTRICAL PRINCIPLE

C66040124-DL
TOTAL 1 SHEET 1
PROJECTION

REV. NO.	REV. CONTENTS	DATE
100	CURRENT VERSION	