

# 4-pole Contactors (400AF)

## Description

- 4-pole main contact
- AC/DC common use coil built
- Wide coil operation voltage
- Screw mountable
- 2NO+2NC Auxiliary contacts built-in as standard
- Side mountable accessories
- Degree of protection: IP20

## Rating



MC-400a/4

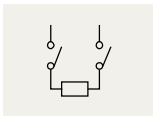

2pole for DC contact

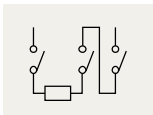

3pole for DC contact

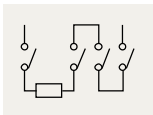

4pole for DC contact

Contactor type			MC-265a/4		MC-330a/4		MC-400a/4	
			kW	A	kW	A	kW	A
AC duty	AC1	200/240V	115	300	135	350	160	420
		380/440V	215	300	250	350	300	420
		500/550V	265	300	315	350	375	420
		690V	335	300	390	350	470	420
	AC3	200/240V	80	265	90	330	125	400
		380/440V	147	265	160	330	200	400
	lth	-	360	-	420	-	500	
DC1 duty (L/R=1ms)	2-pole	110V	-	200	-	200	-	200
	in series	220V	-	200	-	200	-	200
	3-pole	110V	-	265	-	330	-	400
	in series	220V	-	265	-	330	-	400
	4-pole	110V	-	265	-	330	-	400
	in series	220V	-	265	-	330	-	400
<b>UL rating</b>			<b>hp</b>	<b>A</b>	<b>hp</b>	<b>A</b>	<b>hp</b>	<b>A</b>
		220/240V	100	-	125	-	150	-
		440/480V	200	-	250	-	300	-
		550/600V	200	-	250	-	300	-
	lth		-	300	-	350	-	450
Conductor size (solid, stranded)	AWG		3/0~500		4/0~500		350~700	
	mm <sup>2</sup>		95~240		95~240		185~370	
Conductor type			75°C Cu stranded wire					



## Coil voltage, AC/DC common

Nominal(ordering) voltage	AC 50/60Hz	DC
100/200V	100 - 240V	100 - 220V
300V	265 - 347V	-
400V	380 - 450V	-
500V	440 - 575V	-

### Certification

- CE(IEC)
- UL508

## Accessories



**AD-300**  
Delayed opening device  
▶ 81 page

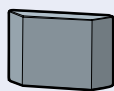

**Safety cover, A7**  
▶ 87 page



**AP-400/4**  
Terminal cover  
▶ 81 page



**AI-180**  
Insulation barrier  
▶ 81 page



**AU-100, 100E**  
Auxiliary contact unit  
side mount, 1NO+1NC  
▶ 78 page



**AR-180**  
Interlock unit  
side mount  
▶ 83 page

# 4-pole Contactors (800AF)

## Description

- 4-pole main contact
- AC/DC common use coil built
- Wide coil operation voltage
- Screw mountable
- 2NO+2NC Auxiliary contacts built-in as standard
- Side mountable accessories
- Degree of protection: IP20

## Rating



MC-800a/4

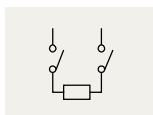

2pole for DC contact

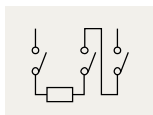

3pole for DC contact

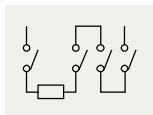

4pole for DC contact

Contactor type			MC-500a/4		MC-630a/4		MC-800a/4	
			kW	A	kW	A	kW	A
AC duty	AC1	200/240V	245	630	255	660	310	800
		380/440V	450	630	470	660	570	800
		500/550V	560	630	590	660	710	800
		690V	710	630	740	660	900	800
	AC3	200/240V	147	500	190	630	220	800
		380/440V	265	500	330	630	440	800
lth		-	630	-	750	-	900	
DC1 duty (L/R=1ms)	2-pole	110V	-	500	-	630	-	630
		220V	-	500	-	630	-	630
	3-pole	110V	-	500	-	630	-	800
		220V	-	500	-	630	-	800
	4-pole	110V	-	500	-	630	-	800
		220V	-	500	-	630	-	800
<b>UL rating</b>			<b>hp</b>	<b>A</b>	<b>hp</b>	<b>A</b>	<b>hp</b>	<b>A</b>
		220/240V	200	-	250	-	300	-
		440/480V	400	-	500	-	600	-
		550/600V	400	-	500	-	600	-
		lth	-	580	-	660	-	900
Conductor size (solid, stranded)		AWG	350~800		600~2000		1700~Busbar	
(the max. number of conducts: 2)		mm <sup>2</sup>	185~480		-		-	
Conductor type			75°C Cu stranded wire					

## Coil voltage, AC/DC common

Nominal(ordering) voltage	AC 50/60Hz	DC
100V	100 - 127V	100 - 110V
200V	200 - 240V	200 - 220V
300V	265 - 347V	-
400V	380 - 450V	-
500V	440 - 575V	-

### Certification

- CE(IEC)
- UL508

## Accessories



**AD-600**  
Delayed opening device  
▶ 81 page

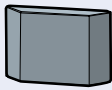

**Safety cover, A7**  
▶ 87 page



**AP-800/4**  
Terminal cover  
▶ 81 page



**AI-600**  
Insulation barrier  
▶ 81 page



**AU-100, 100E**  
Auxiliary contact unit  
side mount, 1NO+1NC  
▶ 78 page



**AR-600**  
Interlock unit  
▶ 83 page